



**St John's Hill**  
**Battersea/Clapham Junction**  
**SW11**

**TO LET**

This first floor studio flat comprises a very spacious living/bedroom plus a kitchen and a bathroom. Very conveniently located, above retail premises, just a short walk from Clapham Junction station.

# St Johns Hill, Battersea, SW11

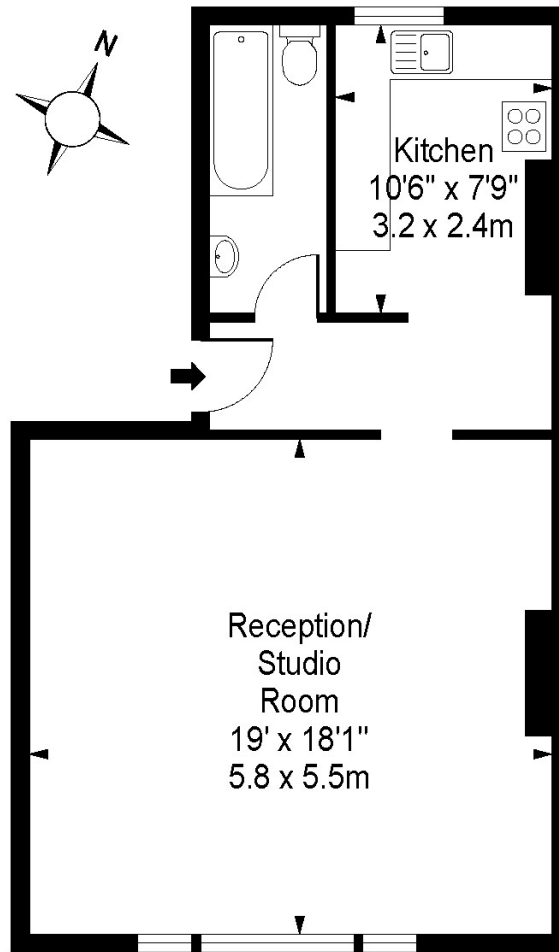

First Floor

Approx Gross Internal Area **532 Sq Ft - 49.4 Sq M**

For Illustration Purposes Only - Not To Scale  
photosandfloorplans.com ©



## PROPERTY FEATURES

- First Floor
- Some Shared Bills
- Residents Parking
- Convenient Location
- Available Immediately
- London Borough of Wandsworth
- Kitchen
- Bathroom
- Large Reception / Bedroom
- 532 Sq Ft / 49.4 Sq M

## VIEWING BY APPOINTMENT ONLY

The particulars do not constitute part of an offer or contract: the particulars including text descriptions, photographs and plans are only for the guidance of prospective purchasers and must not be relied on as statements of fact: nothing in the particulars shall be deemed as a statement that the property is in good condition nor that any services or facilities are in good working order: measurements given are approximate: prior to viewing we recommend that you discuss particular points of interest with a staff member to avoid a wasted journey

